



- The designed by needle bearing bring the powerful clamping force.
- 針狀軸承結構具有強力的鎖固力量

- Two types for choose, with center coolant or with side coolant.
- 可以選擇中心出水或側面出水

- The chuck without collet have  $\varnothing 12, \varnothing 16, \varnothing 20, \varnothing 25, \varnothing 32$ .
- 不含筒夾的本體規格有  $\varnothing 12, \varnothing 16, \varnothing 20, \varnothing 25, \varnothing 32$ .

- Accuracy  $< 0.005\text{mm}$  ( 4XD ) [ without collet ]
- 回轉精度在 $0.005\text{mm}$ 以下 ( 4XD ) ( 不含筒夾 )

## RUN OUT

Accuracy within 0.005mm at 4 times length of cutter edge to ensure uniform an even cutting action, increasing cutting speed and tool life.

## 回轉精度

4倍刃長精度在0.005mm以內，確保切削時每刃刀口的均勻切削，可使切削速度提高及刀具壽命增加。

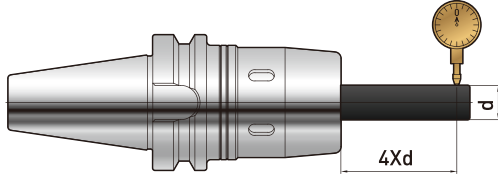

## THE DESIGNED WITH THE NEEDLE BEARING STRUCTURE

The needle bearing have the strong clamping force to arrive the maximum locking capacity up to 3200Nm.

### 針狀軸承結構

具有強力的鎖固力量，最大的鎖固力可達3200Nm。



## DESIGNED BY THICK WALL

The thick wall can absorb the cutting tool vibration to achieve the effect of vibration damping.

### 厚壁設計

可以吸收切削時的刀具震動，達到阻尼減震的效果。



## CHOICE OF COOLING MODE

Through the change of the sealing cover below, you can select the center coolant or side coolant.

### 冷却方式的選擇

經由下面封蓋的改變，可以選擇中心出水或側面出水。



## COMPLETE RANGED OF SPECIFICATIONS

The chuck without collet have  $\varnothing 12$ ,  $\varnothing 16$ ,  $\varnothing 20$ ,  $\varnothing 25$ ,  $\varnothing 32$ . The chuck without collet can ensure that the grip will not be reduced.

### 系統規格完整

不含筒夾的本體規格有 $\varnothing 12$ 、 $\varnothing 16$ 、 $\varnothing 20$ 、 $\varnothing 25$ 、 $\varnothing 32$ ，沒有筒夾的本體，可以確保把握力不會減少。

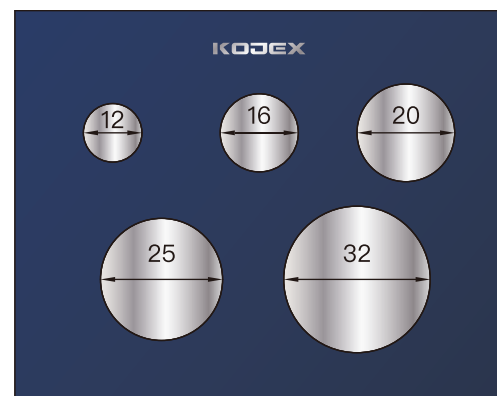

# HPC POWERGRIP CHUCK

HPC 威力夾頭刀柄

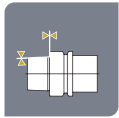
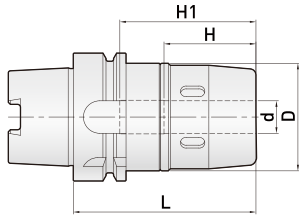

Dual face contact  
兩面接觸

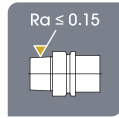

Surface roughness  
表面粗度

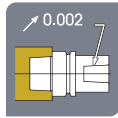

Run out accuracy  
內孔偏擺度



Surface hardness  
表面硬度

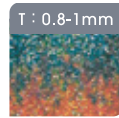

Carbonized depth  
滲碳深度

Order Code 訂購編號	L	D	d	H	H1	Min <sup>-1</sup> G6.3 動態平衡	Spanner 扳手
HSK63A-HPC12-85	85	43	12	43	60	30,000	30194-702
HPC16-90	90	53	16	43	60	30,000	30194-703
HPC20-105	105	57	20	47	75	30,000	30194-704
HPC25-110	110	62	25	57	80	30,000	30194-704
HPC32-120	120	76	32	60	87	30,000	30194-705
HSK100A-HPC25-120	120	62	25	57	85	20,000	30194-704

- Designed by needle bearing, bring powerful clamping force. ● 採用針狀軸承設計，夾持力極佳。
- Suitable for process on high speed and heavy cutting. ● 可同時在高速切削和重切削上使用。
- Spanner must be ordered separately. ● 扳手必須另外訂購。
- H=min tool length / H1=max tool length. ● H=最短銑刀柄長度/H1=最長銑刀柄長度。



## HPC COLLET

HPC 筒夾

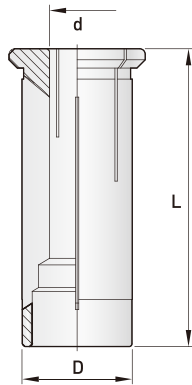

Order Code 訂購編號	d	(d) 夾持徑	L	D
HPC20-6	6	6	54	20
8	8	8		
10	10	10		
12	12	12		
16	16	16		
HPC25-8	8	8	60	25
10	10	10		
12	12	12		
16	16	16		
20	20	20		
HPC32-10	10	10	72	32
12	12	12		
16	16	16		
20	20	20		
25	25	25		

## SPANNER

扳手



Order Code 訂購編號	Type 型式
30194-702	SP-HPC12
703	SP-HPC16
704	SP-HPC20/HPC25
705	SP-HPC32