



- The designed by needle bearing bring the powerful clamping force.
- 針狀軸承結構具有強力的鎖固力量

- Two types for choose, with center coolant or with side coolant.
- 可以選擇中心出水或側面出水

- The chuck without collet have $\varnothing 12, \varnothing 16, \varnothing 20, \varnothing 25, \varnothing 32$.
- 不含筒夾的本體規格有 $\varnothing 12, \varnothing 16, \varnothing 20, \varnothing 25, \varnothing 32$.

- Accuracy $< 0.005\text{mm}$ (4XD)
(without collet)
- 回轉精度在 0.005mm 以下 (4XD)
(不含筒夾)

RUN OUT

Accuracy within 0.005mm at 4 times length of cutter edge to ensure uniform an even cutting action, increasing cutting speed and tool life.

回轉精度

4倍刃長精度在0.005mm以內，確保切削時每刃刀口的均勻切削，可使切削速度提高及刀具壽命增加。

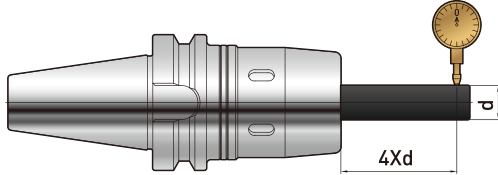

THE DESIGNED WITH THE NEEDLE BEARING STRUCTURE

The needle bearing have the strong clamping force to arrive the maximum locking capacity up to 3200Nm.

針狀軸承結構

具有強力的鎖固力量，最大的鎖固力可達3200Nm。



DESIGNED BY THICK WALL

The thick wall can absorb the cutting tool vibration to achieve the effect of vibration damping.

厚壁設計

可以吸收切削時的刀具震動，達到阻尼減震的效果。



CHOICE OF COOLING MODE

Through the change of the sealing cover below, you can select the center coolant or side coolant.

冷却方式的選擇

經由下面封蓋的改變，可以選擇中心出水或側面出水。



COMPLETE RANGED OF SPECIFICATIONS

The chuck without collet have $\varnothing 12$, $\varnothing 16$, $\varnothing 20$, $\varnothing 25$, $\varnothing 32$. The chuck without collet can ensure that the grip will not be reduced.

系統規格完整

不含筒夾的本體規格有 $\varnothing 12$ 、 $\varnothing 16$ 、 $\varnothing 20$ 、 $\varnothing 25$ 、 $\varnothing 32$ ，沒有筒夾的本體，可以確保把握力不會減少。

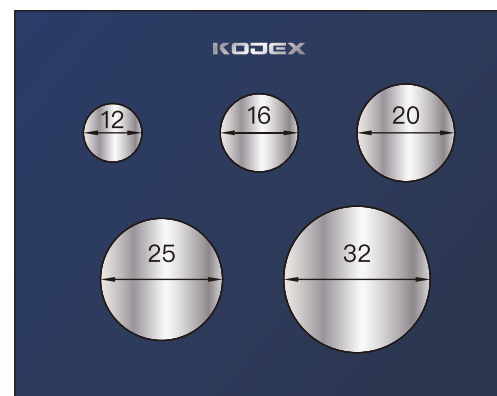

HPC POWERGRIP CHUCK

HPC 威力夾頭刀柄

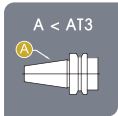
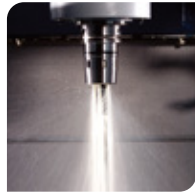
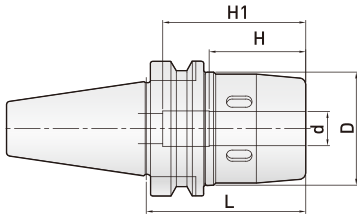

Taper tolerance
錐度公差

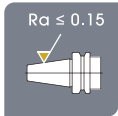

Surface roughness
表面粗度

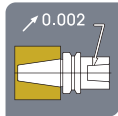

Run out accuracy
內孔偏擺度



Surface hardness
表面硬度

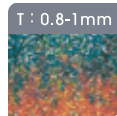

Carbonized depth
滲碳深度

Order Code 訂購編號	L	D	d	H	H1	Min ⁻¹ G6.3 動態平衡	Spanner 扳手
BT30- HPC12-80	80	43	12	43	60	30,000	30194-702
HPC16-90	90	53	16	43	66	30,000	30194-703
HPC20-90	90	57	20	47	90	30,000	30194-704
BT40- HPC12-85	85	43	12	43	60	30,000	30194-702
HPC16-90	90	53	16	43	76	30,000	30194-703
HPC20-90	90	57	20	47	90	30,000	30194-704
HPC25-95	95	63	25	57	90	30,000	30194-704
HPC32-110	110	76	32	60	100	30,000	30194-705
BT50- HPC12-100	100	43	12	43	170	20,000	30194-702
HPC16-100	100	53	16	43	170	20,000	30194-703
HPC20-100	100	57	20	47	170	20,000	30194-704
HPC25-105	105	63	25	57	90	20,000	30194-704
HPC25-150	150	63	25	57	90	20,000	30194-704
HPC32-110	110	76	32	60	100	20,000	30194-705

- Designed by needle bearing, bring powerful clamping force.
- Suitable for process on high speed and heavy cutting.
- Spanner must be ordered separately.
- H=min tool length / H1=max tool length.

- 採用針狀軸承設計，夾持力極佳。
- 可同時在高速切削和重切削上使用。
- 扳手必須另外訂購。
- H=最短銑刀柄長度/H1=最長銑刀柄長度。



HPC COLLET

HPC 筒夾

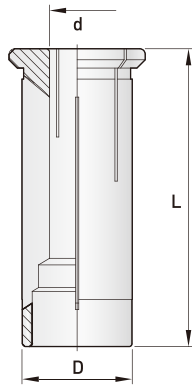

Order Code 訂購編號	d	(d) 夾持徑	L	D
HPC20-6	6	6	54	20
8	8	8		
10	10	10		
12	12	12		
16	16	16		
HPC25-8	8	8	60	25
10	10	10		
12	12	12		
16	16	16		
20	20	20		
HPC32-10	10	10	72	32
12	12	12		
16	16	16		
20	20	20		
25	25	25		

SPANNER

扳手



Order Code 訂購編號	Type 型式
30194-702	SP-HPC12
703	SP-HPC16
704	SP-HPC20/HPC25
705	SP-HPC32